

LET DATE	10.05.06	NEW
REVISION RECORD	C10-J372	Y.N
CHKD		

GENERAL TOLERANCE		10MAX 50MAX 100MAX 250MAX 2500VR	ANGLE	ECCENT	0.1	±30'	±0.75	±30'	0.1
SPECIFIED		±0.3	±0.5	±0.8	±1.4	±2	±30'	±0.15	MASS
APPROVED		10.05.11	10.05.11	10.05.11	10.05.11	10.05.06	10.05.11	10.05.06	10.05.11
CHECKED		丸尾	丸尾	丸尾	丸尾	丸尾	丸尾	丸尾	丸尾
DESIGN		Y. NAGAKA	Y. NAGAKA	Y. NAGAKA	Y. NAGAKA	Y. NAGAKA	Y. NAGAKA	Y. NAGAKA	Y. NAGAKA
DRAWN		丸尾	丸尾	丸尾	丸尾	丸尾	丸尾	丸尾	丸尾
DWG NO.		7321-9847-30							
PART NO.		7321-9847-30							
SET DWG NO.		7321-9847-30:R							
YAZAKI CORPORATION									

CUSTOMER	CUSTOMER PART NO.	CUSTOMER DWG NO.
OFFICE	TRIAL PART NO. OR PRODUCT NO.	
VENDOR	VENDOR NO.	
NAME		
ST-PLUG 15NF		
MATERIAL		
SPEC. SEE TABLE		
TREAT & FIN. SEE TABLE		
ISSUE MARK		

- NOTES
1. THIS PARTS IS TERMINATORS FOR CAN NETWORK OF THE CAR.
 2. MATING PART NO.: 7182-7058-40, 7187-1616
 3. 使用温度範囲: -40~85℃
 4. 最大使用電圧: 15V (但し、端子 3-2 間電位差6V以下)
 5. 本部品は化学物質管理基準 (YGS-C21-010) に準ずる事。
5. MATERIAL DISPLAY OF THIS PART SHALL BE BASED ON TSZ6005G.
 (NOTE: POTENTIAL DIFFERENCE BETWEEN TERMINAL 3-2 SHOULD BE MAX 6V)
4. OPERATIONAL MAX VOLTAGE RANGE: 15V
 3. OPERATIONAL TEMPERATURE RANGE: -40~85℃

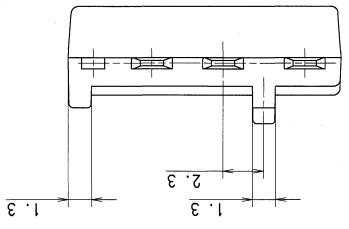
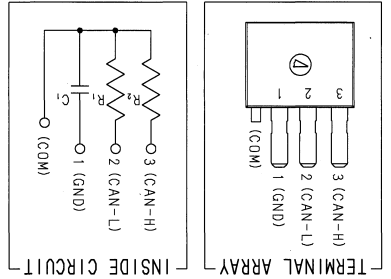
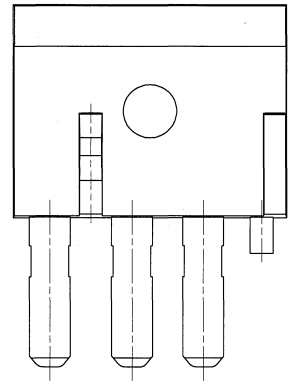
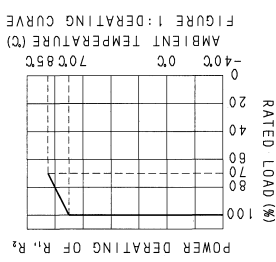
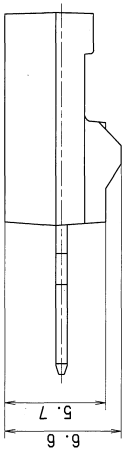
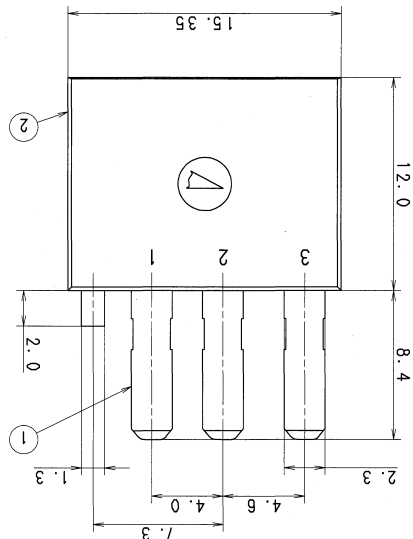
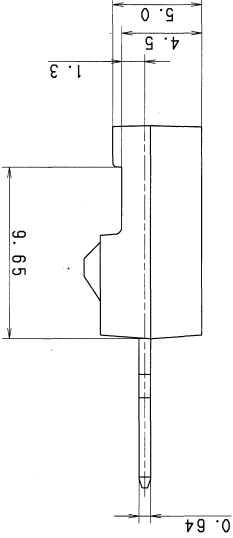
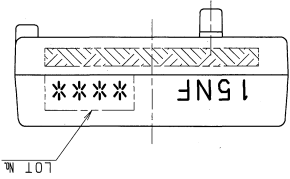

ELECTRICAL CHARACTERISTICS	
ITEMS	CHARACTERISTICS MEASUREMENT SITE
RESISTOR	R1: 60.4±1.0% TERMINAL NO. 2-COM R2: 60.4±1.0% TERMINAL NO. 3-COM
POWER RATED	R1, R2: 0.25W
CAPACITOR	CAPACITANCE 0.015µF±20.0% TERMINAL NO. 1-COM RATED VOLTAGE DC50V

TABLE 1 NO.	YAZAKI PART NAME	MATL. & SPEC.	COLOR
1	TERMINAL	COPPER ALLOY	
2	PACKAGE	EPOXY RESIN	BLACK