

1

2

3

STDLIB-SW2016

GENERAL TOLERANCE				NO.	YAZAKI PART NO.	YAZAKI PART NAME	QTY.	MATERIAL	TREAT. & FIN.	REMARKS
10MAX	±0.5	50MAX	±0.8	①	7206-3728-02	BATTERY TERMINAL BASE STUD N-	1	COPPER ALLOY	PLAT-Sn	—
TOLERANCE	±0.5	100MAX	±1.5	②	7150-1085	SQUARE BOLT	1	SWCH	PLAT-Sn	M6
		250MAX	±2.5	③	7151-1063	NUT	1	SWCH	PLAT-Sn	M6
		2500VR	±3							
		ANGLE	±5°							
		ECCENT	0.3							

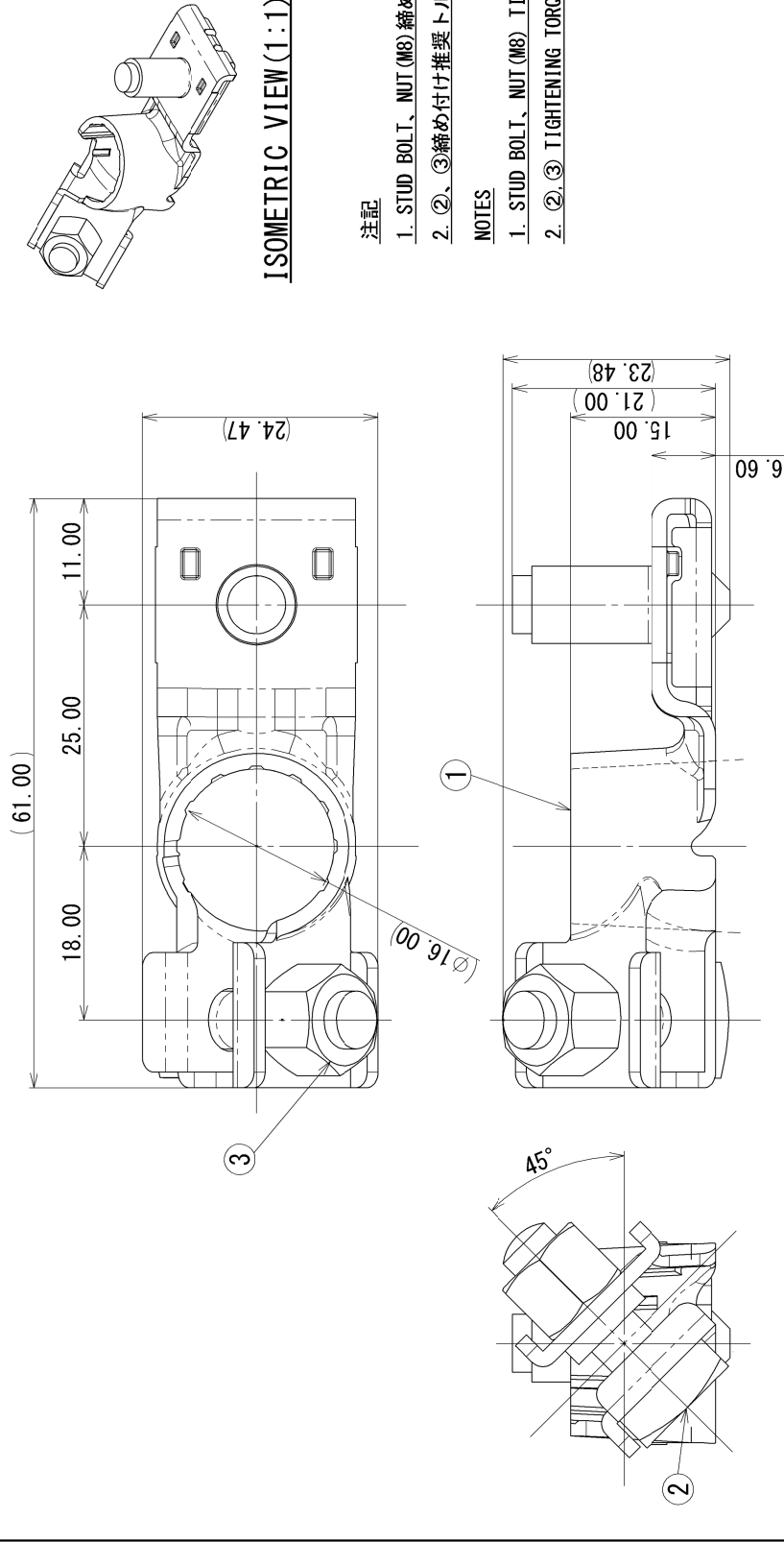

注記

1. STUD BOLT, NUT (M6) 締め付け推奨トルク: 11~14N・m
2. ②、③締め付け推奨トルク : 5~7N・m

NOTES

1. STUD BOLT, NUT (M8) TIGHTENING TORQUE : 11~14N・m
2. ②、③ TIGHTENING TORQUE : 5~7N・m

LET	DATE	REVISION RECORD	NO.	CHKD	Y. M	CUSTOMER	CUSTOMER PART NO.	TRIAL PART NO. or PRODUCT NO.	MATL. SPEC.	SEE TABLE	TREAT. & FIN.	SEE TABLE	ISSUE MARK
	2018/03/15	NEW	C18-Y050										
GENERAL TOLERANCE		10MAX	±0.2	50MAX	±0.3	250MAX	±0.5	2500VR	±0.75	ANGLE	±0.5°	O. 1	
A	±0.15	±0.2	±0.3	±0.5	±0.75	±0.5	±1.0°	±1.0°	±1.4	±1.5°	±1.5°	±1.5	
B	±0.2	±0.3	±0.55	±0.95	±1.4	±1.0°	±1.0°	±1.0°	±1.4	±1.5°	±1.5°	±1.5	
C	±0.3	±0.5	±0.8	±1.4	±2	±1.5°	±1.5°	±1.5°	±1.4	±1.5°	±1.5°	±1.5	
SPECIFIED		MASS		APPROX. 48.8 g		2018/03/15		2018/03/15		2018/03/02		2018/03/15	
						T. KATO		Y. MATSUMOTO		Y. MATSUMOTO		Y. MAEDA	
						APPROVED		CHECKED		DESIGN		DRAWN	
						R		NEW		2:1		3	
						OFFICE		DWG SOURCE		DWG DATE		ANGLE	
						VENDOR		CHECKED		2018/03/15		2:1	
						VENDOR NO.		Y. MATSUMOTO		2018/03/15		3	
						CUSTOMER		Y. MATSUMOTO		2018/03/15		3	
						CUSTOMER PART NO.		Y. MATSUMOTO		2018/03/15		3	
						OFFICE		Y. MATSUMOTO		2018/03/15		3	
						VENDOR		Y. MATSUMOTO		2018/03/15		3	
						VENDOR NO.		Y. MATSUMOTO		2018/03/15		3	
						DWG TYPE		NEW		2018/03/15		3	
						DWG SOURCE		NEW		2018/03/15		3	
						DWG DATE		2018/03/15		2018/03/15		3	
						CHECKED		Y. MATSUMOTO		2018/03/15		3	
						APPROVED		T. KATO		2018/03/15		3	
						DESIGN		Y. MATSUMOTO		2018/03/15		3	
						DRAWN		Y. MATSUMOTO		2018/03/15		3	
						PART NO.		7306-3728-02		2018/03/15		3	
						CH. CODE		7306-3728-02		2018/03/15		3	
						DWG NO.		7306-3728-02:R		2018/03/15		3	
						SET DWG NO.		7306-3728-02:R		2018/03/15		3	
						NAME		BATTERY TERMINAL ASSY STUD N-		2018/03/15		3	
						MATERIAL SPEC.		SEE TABLE		2018/03/15		3	
						TREAT. & FIN.		SEE TABLE		2018/03/15		3	
						ISSUE MARK				2018/03/15		3	

YAZAKI Corporation

3

2

1

A3