

1

TABLE 1

NO.	YAZAKI PART NO.	MATERIAL	COLOR	△QTY.
①	SEE TABLE 2	PBT	SEE TABLE 2	1
②	7157-4355	PBT	NATURAL	1
③	7137-2602-80	SILICONE RUBBER	DARK BROWN	1

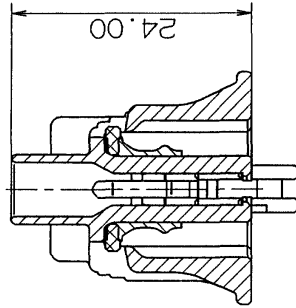

SEC. B-B

A ←

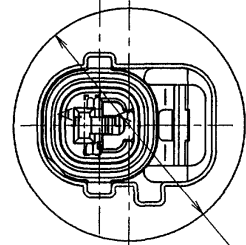

A

2

YAZAKI SUB ASSEMBLY PART NO. 7283-1114 ETC.

TABLE 2

YAZAKI SUB ASSEMBLY PART NO.	YAZAKI PART NO.	COLOR
7283-1114	7183-1114	NATURAL
7283-1114-10	7183-1114-10	DARK GRAY
7283-1114-30	7183-1114-30	BLACK
7283-1114-40	7183-1114-40	LIGHT GRAY
7283-1114-50	7183-1114-50	ORANGE
7283-1114-60	7183-1114-60	GREEN
7283-1114-80	7183-1114-80	BROWN
7283-1114-90	7183-1114-90	BLUE

B

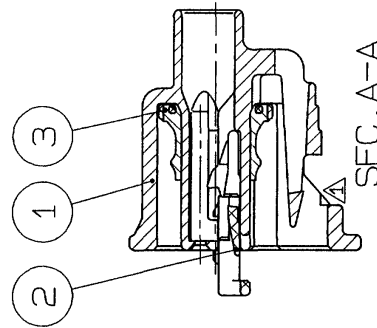

SEC. A-A

注記

1. 透明端子品種 : 7116-4025 ETC.

NOTE

1. APPLICABLE TERMINAL NO. : 7116-4025 ETC.

3

CUSTOMER		CUSTOMER PART NO.		CUSTOMER DWG NO.		MATERIAL SPEC.		TREAT. & FIN.		ISSUE MARK	
C97-L716 H.K		C91-L278 Y.G		NEW		SEE TABLE 1		NAME 090II 1P SEALED CONNECTOR		HOUSING FEMALE SUB ASSEMBLY	
REVISION RECORD		NO. CHKD		VENDOR		TRIAL PART NO.		PART NO. 7283-1114 ETC.		SET DWG NO.	
GENERAL TOLERANCE		ANG		ECCENT		DMG DATE		UNIT		SCL ANGLE	
10MAX 50MAX 100MAX 250MAX		±0.2 ±0.3 ±0.5 ±0.75 ±30' ±30' ±30' ±30'		R		91.10.02		mm		2/1 3	
APPROVED		CHECKED		CHECKED		DESIGN		DRAWN		DWG NO. 7283-1114: R	
Y. K.		Y. K.		Y. K.		TAKEUCHI		YAMAMOTO		7283-1114: R	
97.05.07		97.05.06		97.05.06		90.10.16		97.04.22		YAZAKI CORPORATION	

1

2

3