

RUBBER PART GENERAL TOLERANCE			
PART DIM.	1	2	③
0 TO 3	± 0.2	± 0.3	± 0.4
3 TO 6	± 0.2	± 0.4	± 0.5
6 TO 10	± 0.3	± 0.5	± 0.6
10 TO 18	± 0.3	± 0.6	± 0.8
18 TO 30	± 0.4	± 0.8	± 1.0
30 TO 50	± 0.5	± 1.0	± 1.5
50 TO 80	± 0.6	± 1.2	± 2.0
80 TO 120	± 0.7	± 1.4	± 2.5
120 TO 180	± 0.8	± 1.6	± 3.0
180 TO 250	± 1.0	± 2.0	± 4.0
250 TO 315	± 1.2	± 2.5	± 5.0
315 TO 400	± 1.5	± 3.0	± 6.0
400 TO 500	± 1.8	± 3.5	± 7.0
500 OVER	± 0.4 %	± 0.8 %	± 1.5 %

△	PART NO. AND CH. CODE	MATERIAL	COLOR
	7137-2528-80 (7B37-2528-80)	SILICONE RUBBER	BROWN
△	7137-2528-90		BLUE

注記

1. () 内品番は、エアバッグ (A/B) 回路及び特別
管理回路に使用する時に適用すること。

NOTES

1. PART NUMBERS IN PARENTHESIS SHALL BE USED FOR AIR BAG (A/B)
CIRCUITS AND OTHER CIRCUITS DESIGNATED FOR SPECIAL MONITORING.

B

B

A

A

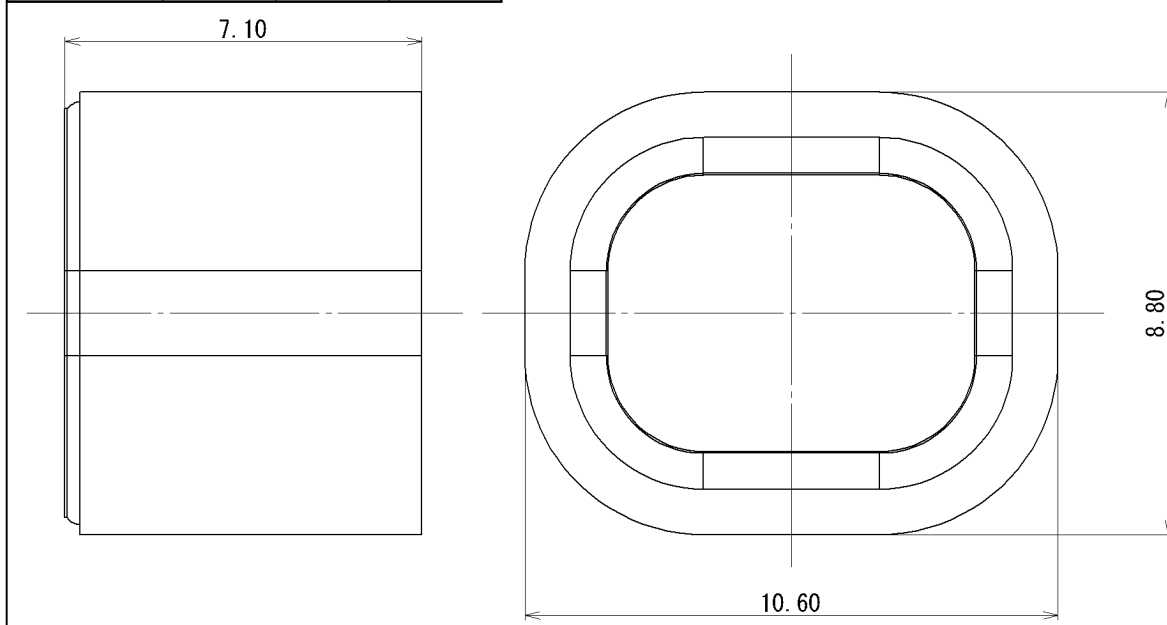

ISSUE MARK

				CUSTOMER		MATL. SPEC. △ SEE TABLE			TREAT. & FIN.						
△ 2012/05/07		ADDED PART NO. ETC		C12-Z440		CUSTOMER PART NO.		CUSTOMER DWG NO.		NAME △ LIP PACKING FOR RV-TYPE					
2003/09/04		NEW		C03-X555		OFFICE		TRIAL PART NO.		HOUSING (2PM)					
LET	DATE	REVISION RECORD		NO.	CHKD	VENDOR									
GENERAL TOLERANCE						VENDOR NO.									
	10MAX	50MAX	100MAX	250MAX	2500VR	ANGLE	ECCENT	DWG TYPE	DWG SOURCE	DWG DATE	UNIT	SCL	ANGLE	PART NO. CH. CODE △ 7137-2528-80 (7B37-2528-80) ETC.	
A	±0.15	±0.2	±0.3	±0.5	±0.75	±30'	0.1	R	NEW	2003/09/04	mm	10:1	3	DWG NO. 7137-2528-80:R	
B	±0.2	±0.3	±0.55	±0.95	±1.4	±30'	0.1	APPROVED	CHECKED	CHECKED	DESIGN	DRAWN		SET DWG NO.	
C	±0.3	±0.5	±0.8	±1.4	±2	±30'	0.15	T. MIWA	K. ANDO		K. ABE	J. BINALLA			
SPECIFIED						MASS								YAZAKI CORPORATION	
								2012/05/07	2012/05/07		1992/11/13	2012/05/07			

1

2

3

