

注記

- 1) 材質: C2600 t=0.64 焼付済み
- 2) 嵌合メス ターミナル品番: 7116-1680-02
- 3) 適用電線サイズ: フロン電線: 0.5~0.75sq

NOTES

- 1) MATERIAL: C2600 t=0.64 TIN PLATING
- 2) MATING FEMALE TERMINAL PART NO.: 7116-1680-02
- 3) APPLICABLE WIRE SIZE: TEFLON WIRW 0.5~0.75sq.

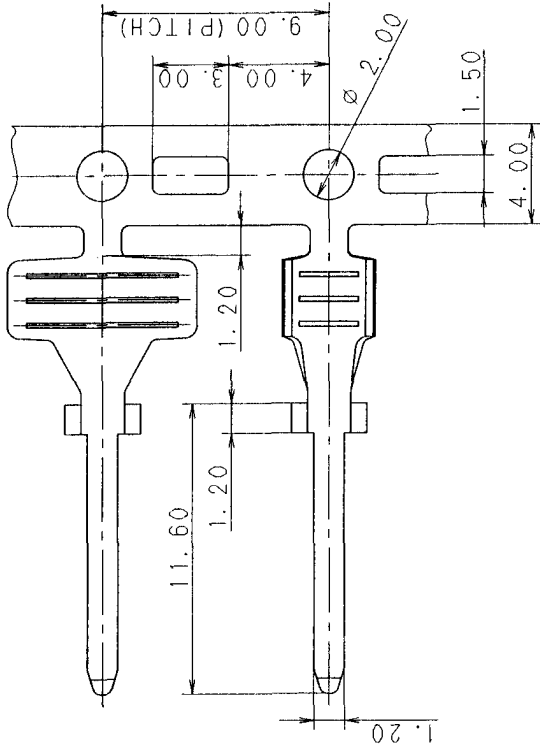

A

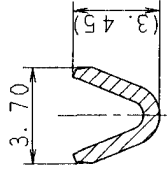
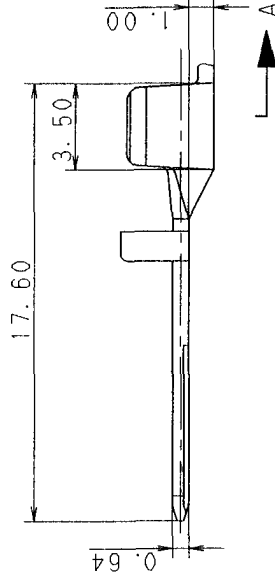
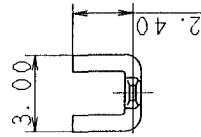

SEC. A-A

ISSUE MARK		MATERIAL SPEC.		SEE NOTES		TREAT. & FIN.	
NAME		SSD TERMINAL MALE (FOR A/T)		PART NO.		7114-1684-02	
CUSTOMER		CUSTOMER PART NO.		CUSTOMER DWG NO.		CH. CODE	
OFFICE		VENDOR		TRIAL PART NO.		DWG NO.	
VENDOR NO.		DWG TYPE		DWG SOURCE		UNIT	
NEW		R		NEW		5/1	
APPROVED		CHECKED		DESIGN		DRAWN	
加藤 明田		畑岸		SANO		SERISAWA	
98.4.25		98.04.24		95.12.18		98.04.22	
C98-L790		N.A		CHKD		9	
REVISION RECORD		NEW		DATE		98.04.22	
GENERAL TOLERANCE		10MAX		±0.2		±0.3	
50MAX		±0.3		±0.5		±0.75	
100MAX		±0.5		±1.4		±1.4	
ANGLE		±30'		±30'		±30'	
ECCENT		0.1		0.1		0.15	
MASS		9		SPECIFIED		SPECIFIED	
DATE		98.04.22		DATE		98.04.22	
ISSUE MARK		TREAT. & FIN.		NAME		SSD TERMINAL MALE (FOR A/T)	
PART NO.		7114-1684-02		CH. CODE		7114-1684-02:R	
DWG NO.		7114-1684-02:R		SET DWG NO.		YAZAKI CORPORATION	